

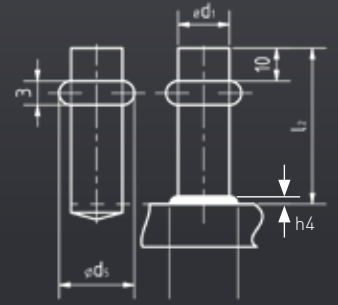

KÖCO KKRB

Drawn arc collar stud

- Material steel, grade 4.8, uncoated.
- Other material and dimensions upon request.



d_1	L_2	d_5	h_4	Part-no.	Mass kg/100	Ceramic ferrule
8	30	14,5	4	Upon request.		UF 8
	35					
	40					
	45					
	50					
	55					
	60					
	65					
	↓					
	100					
10	30	15,5	4	Upon request.		UF 10
	35					
	40					
	45					
	50					
	55					
	60					
	65					
	↓					
	100					